



melvyn
Danes
ESTATE AGENTS

Nailers Close

Auction Guide £39,500

Description

A ground floor one bedroom flat requiring modernisation and refurbishment. An investment opportunity for a BTL property offering a good return.

The property in brief comprises of a lounge, separate kitchen, double bedroom and bathroom.

Set within a popular residential location with high demand locally for BTL properties and close to a wide range of local amenities, shops and transport links.

Auction Details

The sale of this property will take place on the stated date by way of Live streamed auction and is being sold under the Unconditional sale type.

Binding contracts will be exchanged at the point of sale.

All sales are subject to our Common Auction Conditions and Bidder Terms. Properties located in Scotland and Northern Ireland will be subject to applicable local laws.

Auction Deposit and Fees

The following deposits and non-refundable auctioneers fees apply:

- 5% deposit (subject to a minimum of £5,000)
- Buyer's Fee of 4.8% of the purchase price (subject to a minimum of £6,000 inc. VAT)

There may be additional fees listed in the Special Conditions of Sale, which will be available to view within the Legal Pack. You must read the Legal Pack carefully before bidding.

Additional Information

For full details about our auction processes, please refer to the Bidder Terms which can be viewed on our home page.

This explains the types of auction and sale methods we offer, the bidding registration process, your payment obligations, and how to view the Legal Pack (and any applicable home report for residential Scottish properties).

Guide Price & Reserve Price

Each property sold is subject to a Reserve Price. The Reserve Price will be within + or - 10% of the Guide Price. The Guide Price is issued solely as a guide so that a buyer can consider whether or not to pursue their interest. A full definition can be found within the Buyers Terms.

General



Accommodation

Reception Room

16'0" x 9'6" (4.9m x 2.9m)

Kitchen

10'5" x 5'2" (3.2m x 1.6m)

Bedroom

10'5" x 11'5" (3.2m x 3.5m)

Bathroom

5'10" x 5'6" (1.8m x 1.7m)

TERMURE: We are advised that the property is LEASEHOLD. Any ground rent and service charge review periods will be confirmed in the lease documents within the legal pack.

These particulars are for general guidance only and are based on information supplied and approved by the seller. Complete accuracy cannot be guaranteed and may be subject to errors and/or omissions. They do not constitute representations of fact or form part of any offer or contract. Any Prospective Purchaser should obtain verification of all legal and factual matters and information from their Solicitor. Licensed Conveyancer or Surveyors as appropriate. The agent has not sought to verify the legal title of the property and the buyers must obtain verification from their solicitor. Photographs are provided for illustrative purposes only and the items shown in these are not necessarily included in the sale, unless specifically stated. The agent has not tested any apparatus, equipment, fixtures, fittings or services mentioned and do not by these Particulars or otherwise verify or warrant that they are in working order.

BROADBAND/MOBILE: Please refer to checker www.ofcom.gov.uk for broadband and mobile coverage at the property. From data taken on 22/05/2026 we understand that the standard broadband download speed at the property is around 6 Mbps, and the estimated fastest download speed currently achievable for the property post code area is around 1800 Mbps. Actual service availability or speeds received may be different and may vary depending on the time a speed test is carried out. Mobile coverage can vary depending on the network provider and other factors that can affect the local mobile reception and actual services available may be different depending on the particular circumstances, precise location and network outages.

MONEY LAUNDERING REGULATIONS: Under anti-money laundering legislation, we are obliged to confirm the identity of individuals and companies and the beneficial owners of organisations and trusts before accepting new instructions, and to review this from time to time. To avoid the need to request detailed identification information from vendors and intending purchasers, we may use approved external services which review publicly available information on companies and individuals. However, should those checks, for any reason, fail adequately to confirm identity, we may write to you to ask for identification evidence. If you do not provide satisfactory evidence or information within a reasonable time, we may have to stop acting for you and we would ask for your co-operation in order that there will be no delay in agreeing a sale. Any purchaser who has a provisional offer accepted via this company will be liable to pay an administration fee of £25 (incl VAT) for each person connected with the transaction to cover these checks. If we are instructed by a third party selling agent they may carry out their own AML checks and any prospective purchaser will be required to pay any additional costs involved – please speak to the office for confirmation.

REFERRAL FEES: We may refer you to recommended providers of ancillary services such as Conveyancing, Financial Services and Surveying. We may receive a commission payment fee or other benefit (known as a referral fee) for recommending their services. You are not under any obligation to use the services of the recommended provider.

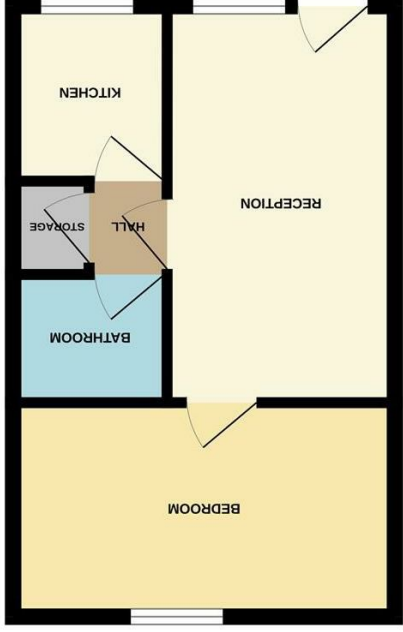
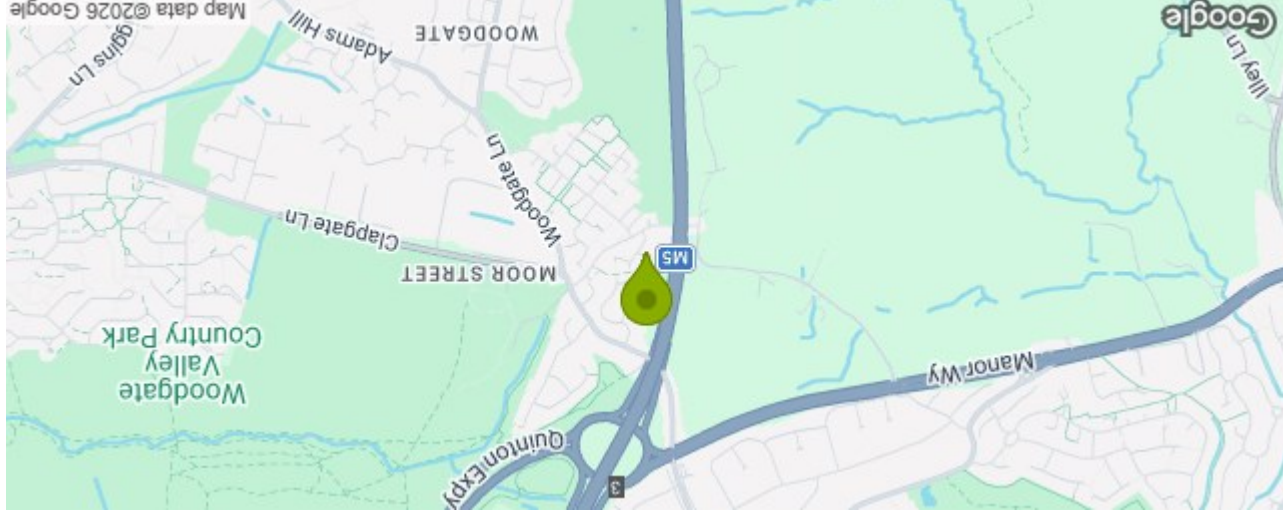

GROUND FLOOR

**24 Nailers Close Birmingham B32 3QR
Council Tax Band:**

| Energy Efficiency Rating | |
|-------------------------------------------------------|--------------------|
| Potential | 79 |
| Current | 60 |
| England & Wales EU Directive 2002/91/EC | |
| Very energy efficient - lower running costs | (92 plus) A |
| | (81-91) B |
| | (69-80) C |
| | (55-68) D |
| | (39-54) E |
| | (21-38) F |
| Not energy efficient - higher running costs | (1-20) G |

Please note that all measurements and floor plans are approximate and quoted for general guidance only and whilst every attempt has been made to ensure accuracy, they must not be relied on and do not form part of any contract.